

TOILET JACKLEG UNITS

12ft x 9ft
2 Berth

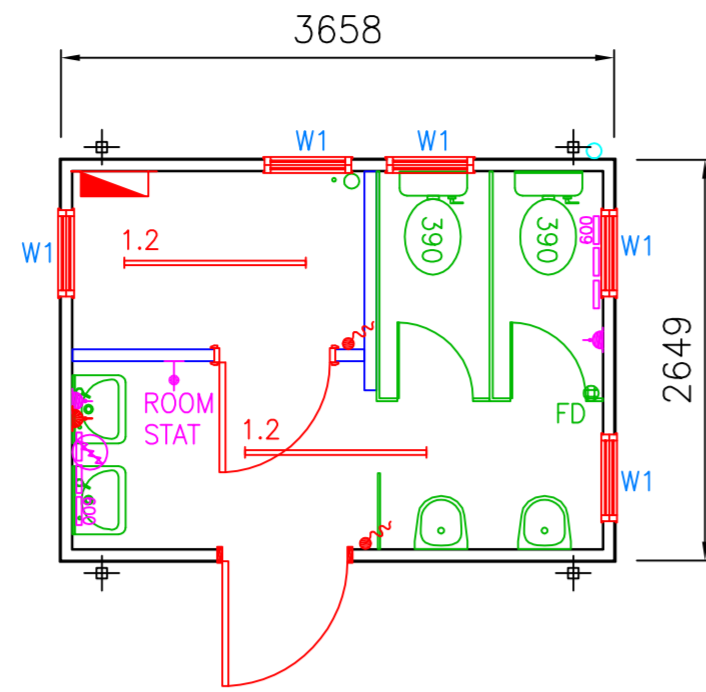

12ft x 9ft
2 + 1
Berth

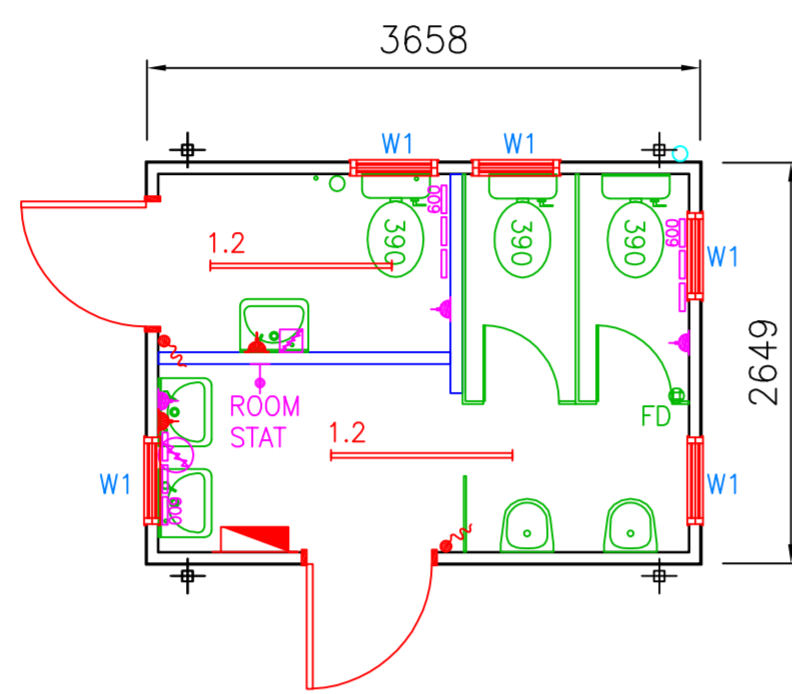

12ft x 9ft
3 Berth

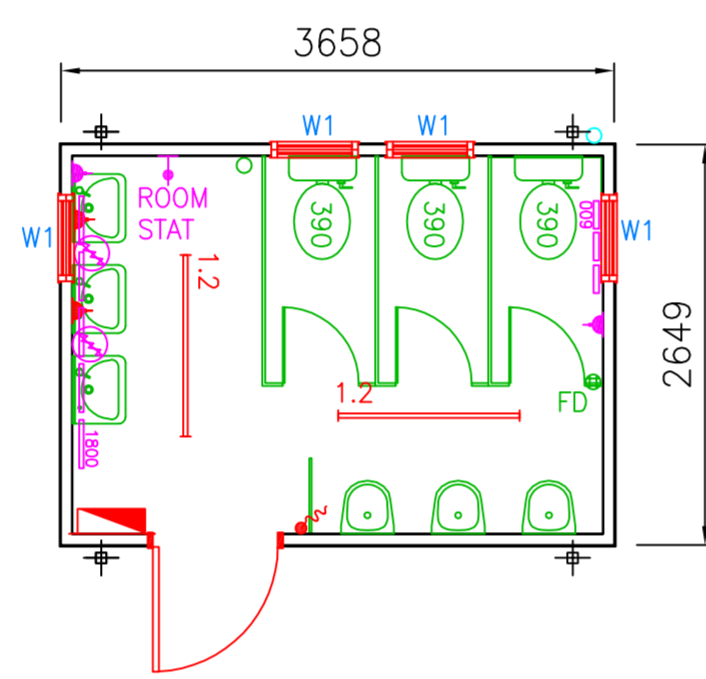

16ft x 9ft
3 + 1
Berth

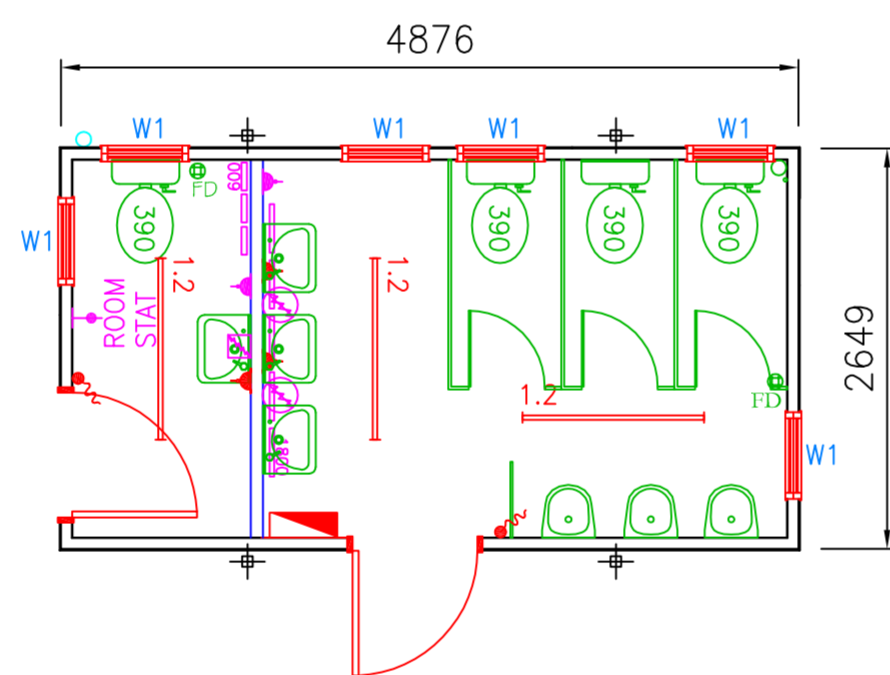



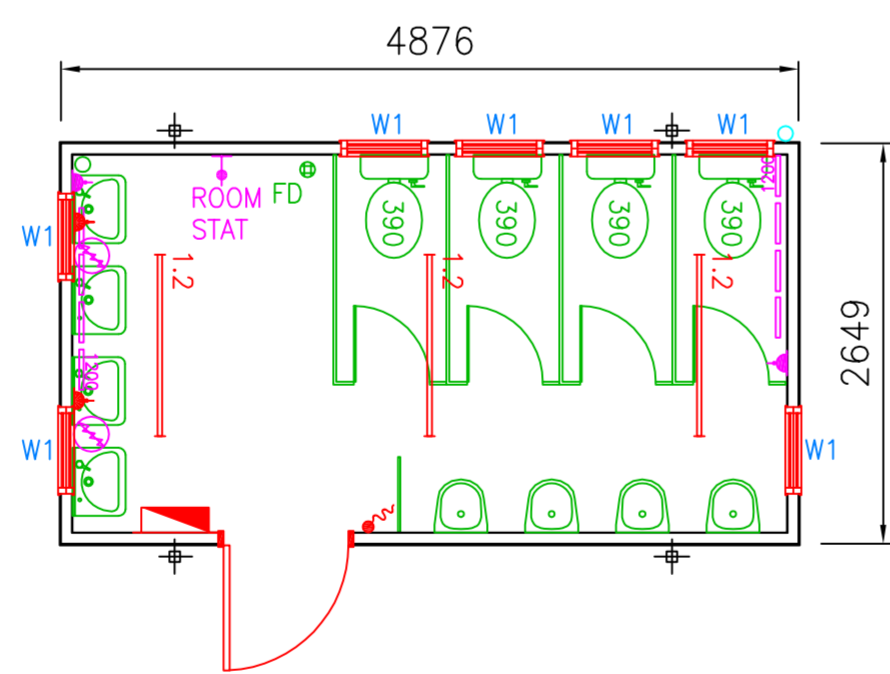



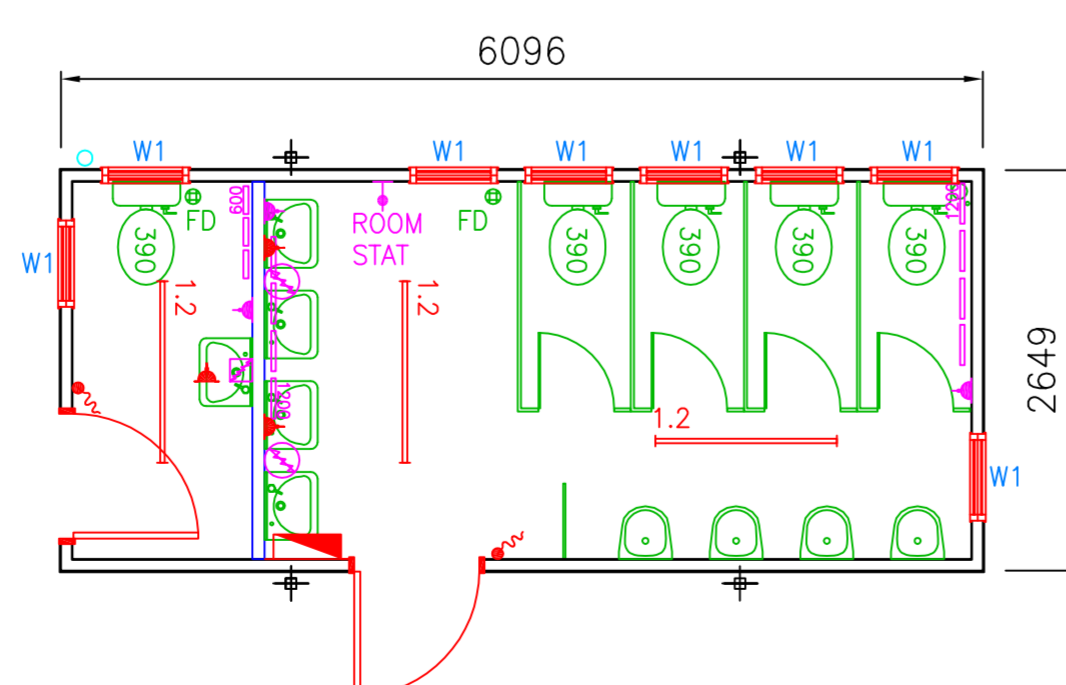

















16ft x 9ft
4 Berth



20ft x 9ft
4 + 1
Berth



-  MAINSBOARD
-  13A DOUBLE SOCKET (450mm AFFL)
-  13A HIGH LEVEL DOUBLE SOCKET (1100mm AFFL)
-  20A DOUBLE POLE LIGHTSWITCH
-  1.2 1200mm SINGLE FLUORESCENT LIGHT
-  1.5 1500mm SINGLE FLUORESCENT LIGHT
-  10A TWO WAY LIGHTSWITCH
-  1.8 1800mm SINGLE FLUORESCENT LIGHT
-  2D 28W INTERNAL LIGHT
-  6A DOUBLE POLE PULLSWITCH
-  2Kw CONVECTOR HEATER
-  1200mm TUBULAR HEATER
-  FROST THERMOSTAT
-  UNDER SINK WATER HEATER
-  WATER HEATER WITH BLENDER
-  600mm TUBULAR HEATER
-  ROOM THERMOSTAT
-  3Kw INSTANT WATER HEATER
-  7ltr OVERSINK STORAGE HEATER C/W SWINGING ARM
-  1800mm TUBULAR HEATER
-  LH SINK/DRAINER
-  URINAL
-  ADULT HEIGHT WC PAN/CISTERN
-  WASH HAND BASIN